

<b>Asset Ref No.</b>	<b>LDY014:005, Managh Beg: possible Motte &amp; Bailey</b>	
<b>Heritage Type</b>	Built	
	<i>Medieval settlement site</i>	
<b>Location</b>	OS 6-inch map sheet	014
	Townland	Managh Beg
	Parish	Clondermot
	LCA	Burngibbagh & Drumahoe
	ITM Coordinates	247660;415930
	NG Coordinates	C4766015930
<b>Protection Status</b>	Scheduled	
<b>Condition</b>	Substantial remains	
<b>Ownership (if known)</b>		
<b>Site Description</b>	<p>This site was included by McNeill as a probable motte &amp; bailey. It is on an area of rock outcrop on the E side of the Faughan R. valley, with land dropping steeply to N. The site consists of a mound, 8-15m high, with an oval summit 48.5m x 26.7m, with a lower, sub-rectangular enclosure, separated from the mound by a ditch 7.7m wide, 8m below the mound &amp; 2m below the enclosure. The enclosure/bailey is 45m x 55m &amp; slopes to N &amp; is bisected by a field boundary. There is an outer bank along the S edge of the bailey. Much of the site is natural &amp; would appear to have very little artificial fashioning, apart from the ditch along the N side.</p>	
<b>Landscape Context (setting)</b>	On an area of rock outcrop on the E side of the Faughan R. valley, with land dropping steeply to N.	
<b>Site Appraisal</b>	Substantial remains of a possible motte and bailey. This is a scheduled site due to the rarity value and substantial remains of same.	
<b>Sensitivity</b>	In prominent location and is a prominent landmark.	
<b>Associations</b>	No documentary associations for its use.	
<b>Recommendations</b>	<p>A good example of its type this could be a good demo training site/place for guided tour/individual tourist experience. Access and land ownership details would require investigation.</p> <p>MCNEILL, T.E., UJA 38, 1975, 54 NO.118</p>	

Mapping

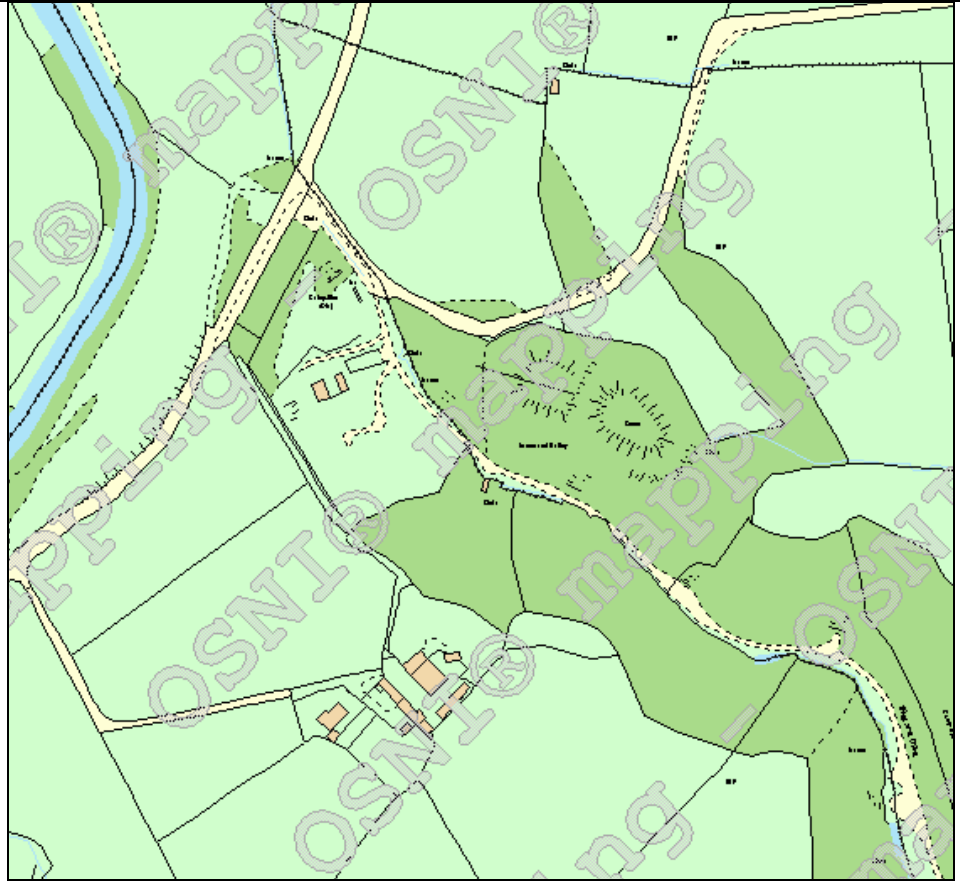

Present-day mapping extract ([www.osni.gov.uk](http://www.osni.gov.uk))

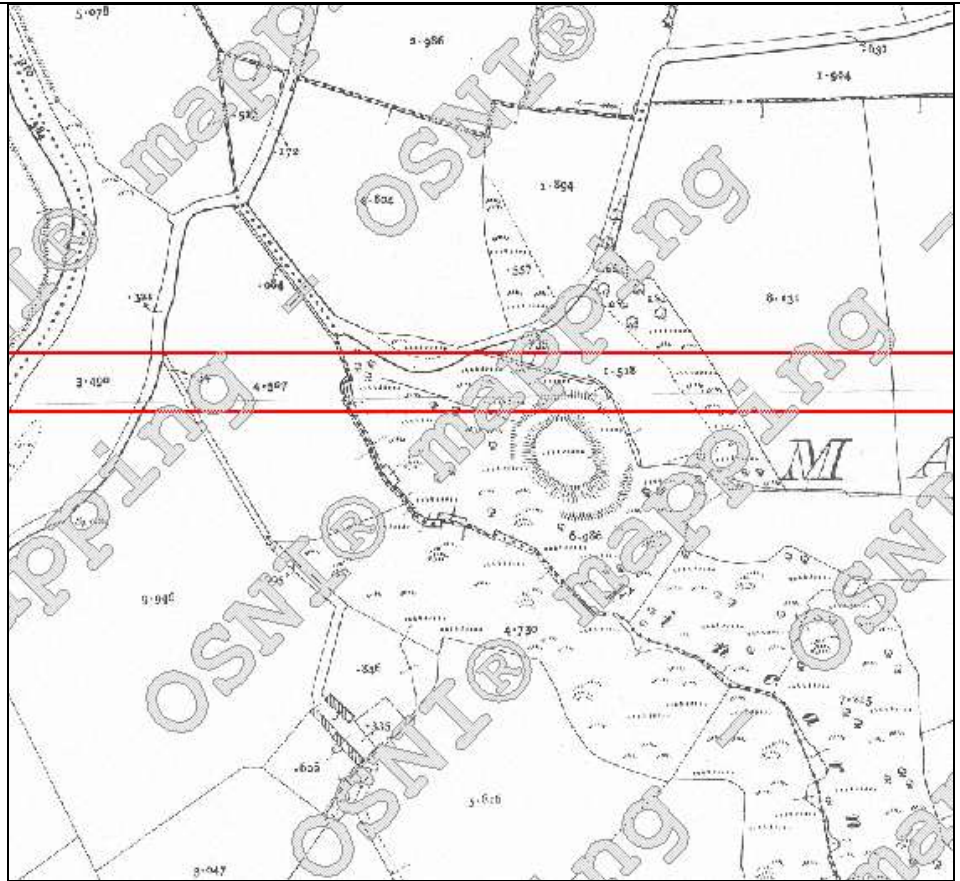

1<sup>st</sup> edition 25-inch OS map extract 1873-1954



Extract from NIEA SMR MapViewer of the site (Map ID No. 1)

References	<a href="http://maps.ehnsi.gov.uk/MapViewer/Default.aspx">http://maps.ehnsi.gov.uk/MapViewer/Default.aspx</a>
Plates	
Additional Notes	