

Asset Ref No.	LDY014:015 Domnach Dola, Church & graveyard: Enagh; HB/01/05/001 Enagh House, Campsie; Registered Garden	
Heritage Type	Built	
	<i>Ecclesiastical site</i>	
Location	OS 6-inch map sheet	015
	Townland	Templetown
	Parish	Clondermot
	LCA	Foyle Alluvial Plain
	ITM Coordinates	246870, 419550
	NG Coordinates	C4687019550
Protection Status	Scheduled	
Condition	Some remains	
Ownership (if known)		
Site Description	<p>Set on top of a drumlin ridge between eastern and western Lough Enagh, this church overlooks the crannog and O'Cahan's castle (LDY014:009 & LDY014:010) in the E lough. The church is almost totally ruinous, with only the E end standing to gable height and a portion of the SE corner of the S transept or side-chapel. It measures approx. 28m x 7m internally, built in local schist dressed on the outside face. A tall narrow lancet window is in the E gable. The masonry of the S transept is superior and obviously later. The interior of the church is very uneven, largely due to the number of burials and both church and graveyard are overgrown. A feature of the graveyard is the large number of graves marked only by stones and slabs of schist.</p> <p>This may be the site of the church recorded in the Annals of Ulster as pillaged by Rortsel Fitton in 1197 and may have been founded by St. Canice. It was the medieval church of Clondermot, with the transept added in later times. A simple stone cross 18m E of the main gate may be a relic of earlier ecclesiastical activity, but there is no sure way of dating it.</p> <p>Enagh Country House located on this ridge. This is also a registered garden.</p>	
Landscape Context (setting)	Set on top of a drumlin ridge between eastern and western Lough Enagh.	
Site Appraisal	An important site, it may have been founded by St. Canice and pillaged in 1197.	
Sensitivity		
Associations	It was the medieval church of the parish of Clondermot and overlooks the O'Cahan stronghold on Enagh Lough. Enagh House and registered garden comprise this location also.	
Recommendations	<p><i>Further reading:</i></p> <p>JRSAI, 32, 1902 282-3</p> <p>Munn, 1925, 93</p> <p>OS Field Report No. 93</p> <p>Reeves W., 1850, 28-9 & 1587, 19</p> <p>Sampson, 1814, 224-5</p>	

Appendix 2: Foyle Alluvial Plain

LDY014:015 Domnach Dola, Church & graveyard: Enagh;
HB/01/05/001 Enagh House, Campsie; Registered Garden

Mapping

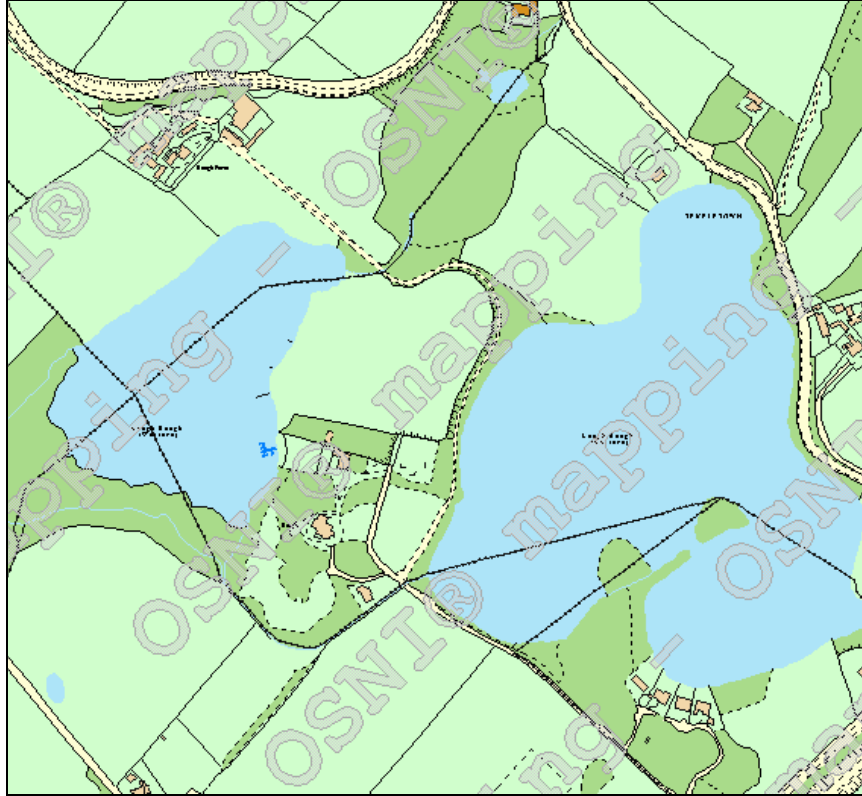

Present-day mapping extract (www.osni.gov.uk)

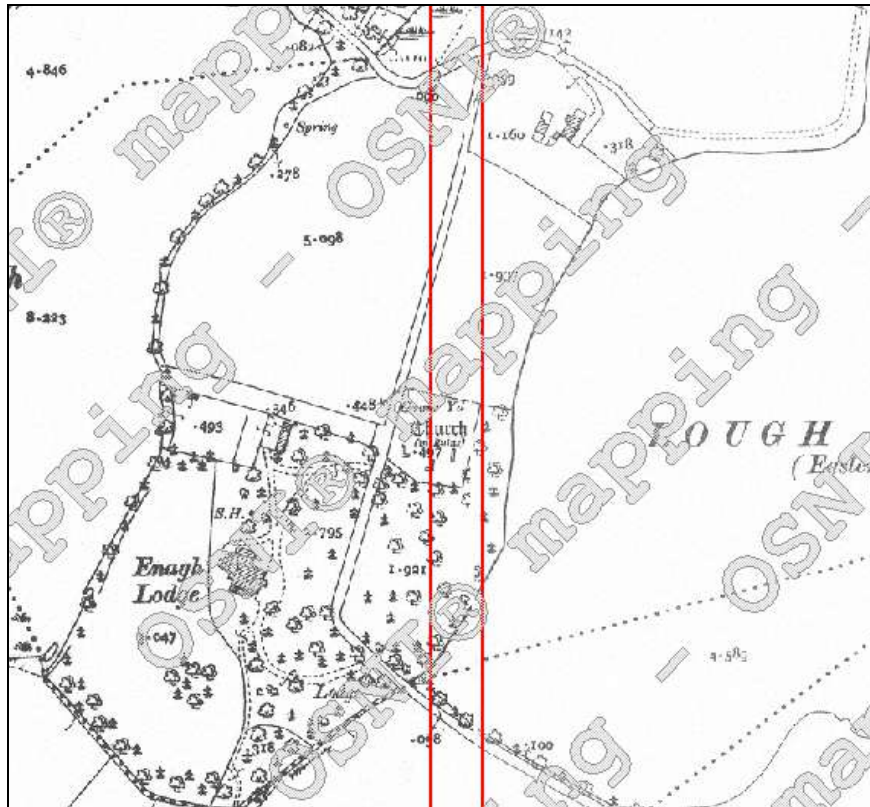

1st edition 25-inch OS map extract 1873 – 1854

Appendix 2: Foyle Alluvial Plain

LDY014:015 Domnach Dola, Church & graveyard: Enagh;

HB/01/05/001 Enagh House, Campsie; Registered Garden

	 <p data-bbox="472 842 1128 871"><i>Extract from NIEA SMR MapViewer of the site (Map ID No. 2)</i></p>
References	http://maps.ehsni.gov.uk/MapView/Default.aspx
Plates	
Additional Notes	

Appendix 2: Foyle Alluvial Plain

*LDY014:015 Domnach Dola, Church & graveyard: Enagh;
 HB/01/05/001 Enagh House, Campsie; Registered Garden*